



# An everyday office essential

DELL 20 MONITOR | E2016HV



## ESSENTIAL FEATURES

Discover the important monitor features you need to drive productivity everyday.



## DEPENDABLE PERFORMANCE

Count on our stringent quality standards that help ensure dependable performance helping minimize workforce downtime.



## ECO-ELEGANT DESIGN

Eco-friendly chassis, made of more than 25% post-consumer recycled materials.



## TRUSTED RELIABILITY

As the world's #1 monitor brand\*, we take pride in our unyielding commitment to quality and the utmost satisfaction of our customers.

# Affordable, reliable, eco-friendly



## ESSENTIAL FEATURES

**Screen performance:** View your applications, spreadsheets and more on 18.5 inches of 1600x900 HD clarity with 16.7 million colors.

**Easy connectivity:** Compatible with legacy PCs via VGA connectivity

**Tilt at will:** Work comfortably by tilting the monitor 5° forward or 21° backward.



## DEPENDABLE PERFORMANCE

**Uncompromised testing:** Rigorous development processes help ensure consistent, reliable performance in busy POS and office environments.

**Convenient controls:** Easily access buttons for power, brightness, contrast and customizable preset modes on the monitor's front panel.

**Mounting option:** Create AIO-like simplicity in deployment by mounting a Dell Wyse thin client or Dell Optiplex Micro PC directly to available rear VESA mount area.



## ECO-ELEGANT DESIGN

**Designed with the environment in mind:** BFR/PVC-free monitor (except external cables) with arsenic-free glass and mercury-free LED panel with more than 25% post consumer plastics in its chassis.

**ENERGY STAR®, EPEAT® registered where applicable<sup>1</sup> and CECP Certified:** Meets all regulatory and environmental standards.

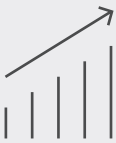

## DELL DISPLAY MANAGER

**More ways to multitask:** Work conveniently across multiple screens and select from predefined templates with the **Easy Arrange** feature on Dell Display Manager software. Quickly tile and arrange your applications and get back to work faster with **Auto-restore**, a feature that remembers where you left off.

**Easily optimize your view:** Automode easily configures display settings for a great front of screen experience.

**Manage your display inventory:** Generate an asset management report to tag display ID and settings within your business environment.



THANK YOU FOR  
MAKING DELL  
MONITORS  
#1 WORLDWIDE\*

**Minimize downtime:** Your monitor comes with a 3-year Advanced Exchange Service<sup>2</sup> so that if a replacement becomes necessary, it will be shipped to you the next business day during your 3-year Limited Hardware Warranty.<sup>3</sup>

**Get a higher level of support:** Upgrade to 24x7, in-region technical phone support from qualified engineers with Dell ProSupport option.<sup>4</sup>

# Features & Technical Specifications

<b>Monitor</b>	Dell 20 Monitor – E2016HV
Diagonal Viewing Size	49.41 cm (19.5 inches)
Active Display Area	
Horizontal	432.0 ± 1.92 mm (17.0 ± 0.08 inches)
Vertical	239.76 ± 3.42 mm (9.44 ± 0.13 inches)
Maximum Preset Resolution	1600 x 900 at 60 Hz
Aspect Ratio	16:9
Pixel Pitch	0.2712 ± 0.0012 x 0.2626 ± 0.0074 mm
Brightness	200 cd/m <sup>2</sup> (typical)
Color Support	Color Gamut (typical): 85% <sup>5</sup> (CIE1976) Color Depth: 16.7 million colors
Contrast Ratio	600:1 (typical)
Viewing Angle	50° to 65°/90°
Response Time	5 ms black-to-white (typical)
Panel Type	TN (active matrix –TFT LCD), anti-glare
Backlight Technology	LED
Optional Soundbar	AC511
<b>Connectivity</b>	
Connectors	VGA only
<b>Design Features</b>	
Adjustability	Tilt only (Typical: 5° forward or 21° backward)
Security	Security lock slot (security lock not included)
Flat Panel Mount Interface	VESA mounting support 100 mm x 100 mm
<b>Power</b>	
AC input voltage/frequency/current	100 to 240 VAC/50 or 60 Hz ± 3 Hz/1.0 A (typical)
Power Consumption (Operational)	14W (typical)
Power Consumption (ENERGY STAR®)	13.3W
Power Consumption Stand by / Sleep	Less than 0.3 W
<b>Dimensions (with stand)</b>	
Height	368.9 mm (14.52 inches)
Width	471.5 mm (18.56 inches)
Depth	167.0 mm (6.57 inches)
<b>Weight</b>	
Weight (panel only – no stand)	2.26 kg (4.98 lb)
Weight (with stand)	3.02 kg (6.66 lb)
Shipping Weight	4.11 kg (9.06 lb)
<b>Standard Service Plan</b>	3 Years Advanced Exchange Service <sup>2</sup> & 3 Years Limited Hardware Warranty <sup>3</sup>
<b>Optional Service Plan</b>	Dell ProSupport <sup>4</sup>
<b>Environmental Compliance</b>	ENERGY STAR®, EPEAT® registered where applicable <sup>1</sup> , CECP, China Energy Label, RoHS

## What's in the box?

### Components

- Monitor panel
- Stand (riser and base)
- VESA trim cover

### Cables

- VGA cable
- Power cable

### Documentation

- Quick Setup Guide
- Safety and regulatory information
- Drivers and documentation media

# Adjustability and connectivity

## DELL 20 MONITOR | E2016HV

Easily adjust the panel to your preferred viewing position.



Back view - Cable management slot



Tilt

### Connectivity

Image enlarged and cropped to show detail

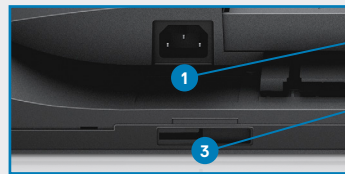

- 1 AC power
- 2 VGA
- 3 Sound bar mounting slots

## RECOMMENDED ACCESSORIES



### DELL DOCKING STATION (USB 3.0) D3100

Connect to any PC to this USB 3.0 universal docking station and display Ultra HD 4K resolution.



### DELL SOUNDBAR - AC511

Get stereo surround sound with the Dell soundbar. Snap it snugly onto the bottom of the monitor to enjoy high-quality audio.

\* Dell monitors are #1 Worldwide for 6 consecutive years (2013 to 2018)! Source: IDC Worldwide Quarterly PC Monitor Tracker, Q4 2018.

1 EPEAT registered where applicable. EPEAT registration varies by country. See [www.epeat.net](http://www.epeat.net) for registration status by country.

2 Advanced Exchange: Dell will send you a replacement monitor the next business day in most cases, if deemed necessary after phone/online diagnosis. Shipping times may vary by location and for monitors 55" and above. Fee charged for failure to return defective unit. See [dell.com/servicecontracts/global](http://dell.com/servicecontracts/global).

3 For a copy of the Limited Hardware Warranty, write to Dell USA LP, Attn: Warranties, One Dell Way, Round Rock, TX 78682 or see [dell.com/warranty](http://dell.com/warranty).

4 Availability varies, please visit [www.dell.com/support](http://www.dell.com/support) for details.

5 Color gamut (typical) is based on CIE1976 (86%) and CIE1931 (72%) test standards.

[Dell.com/monitors](http://Dell.com/monitors) Product availability varies by country. Please contact your Dell representative for more information.

© 2019 Dell. All rights reserved.

Trademarks or trade names may be used in this document to refer to either the entities claiming the marks and names of their products. Dell disclaims proprietary interest in the marks and names of others. Reproduction in any manner whatsoever without express written permission from Dell is strictly forbidden.

