



## HP Docking Stations for HP Business Notebook PCs

Mobile convenience; desktop productivity

### Mobility without sacrifice

Today's notebooks offer the freedom of mobility and the performance of a desktop PC, but on their own, they fall short of delivering the true comfort and convenience of a desktop-like workspace. For highly mobile users who are constantly on the go, the tedious task of plugging and unplugging numerous cords into their notebook several times a day can consume valuable time, increase stress and frustration, and ultimately cut into productivity. It can also lead to physical fatigue if their workspaces are not equipped with comfort-enhancing viewing solutions, such as HP monitor stands. Even for users who rarely pack up their notebooks and work away from their desks, the occasional hassle of connecting multiple peripherals directly into their notebooks is still an inconvenience.

At HP, we've created progressive solutions that address these challenges by delivering the best of both worlds: HP Docking Stations for HP Business Notebook PCs. Whether you travel frequently or rarely leave your desk, our new line of docking stations and line of monitor stands let you enjoy the efficiency and productivity of a desktop PC, and the comfort of a desktop-like workspace, all without sacrificing the convenience and mobility of your 2009 or later<sup>1</sup> HP business notebook.

### Greater connectivity options

For a true desktop-like experience, HP Docking Stations and HP Advanced Docking Stations offer up to six USB ports, enabling you to instantly connect to the USB peripherals you use most. Simply click your HP business notebook into the dock, and you're ready to be productive—there's no need to crawl beneath the desk or mess with a tangle of cords. The docking stations also feature up to two Video DisplayPort connectors, in addition to DVI and VGA ports, giving you multiple choices for high-end digital video output—now and into the future. Users who regularly work with large graphics files can appreciate the new eSATA port on the HP Advanced Docking Station, which offers throughput rates of up to 3 Gbps for transferring massive files quickly and efficiently. And because HP Docking Stations are proactively designed with the future in mind, they're ready to seamlessly accommodate new connectivity standards when they arrive.

1. Due to technology changes, older notebook models may be supported by different docking stations. Please refer to the following models for additional information:

HP 2008 120W Docking Station	KP080AA
HP 2008 150W Advanced Docking Station	KP081AA
HP 2008 150W Docking Station	KQ751AA
HP 2008 180W Advanced Docking Station	KQ752AA
HP 2400/2500 Series Docking Station	EQ773AA

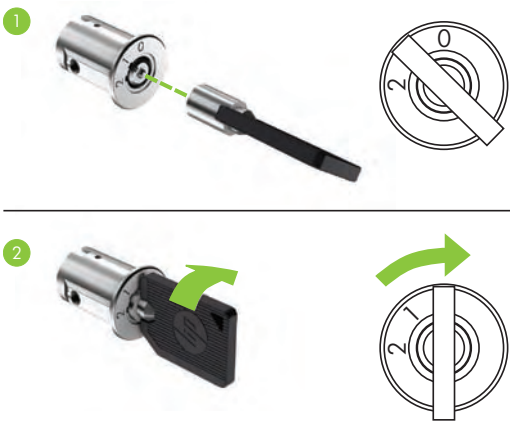

## Simplified and enhanced security

Because protecting your physical notebook and the valuable personal and business data on your notebook are always priorities, HP Docking Stations enable the proprietary HP Docking Station Cable Lock<sup>2</sup> (AU656AA). This new locking solution is dramatically simpler to use than previous locks and delivers enhanced security—just slide the cable lock into the rear slot of your docking station, then insert the locking bolt into the side slot and turn the key. Your devices and data are now more secure! Combined with other physical security features, the HP Docking Station Cable Lock gives you three locking options: lock the docking station only (which also prevents access to the advanced docking station's drive bay), lock both the docking station and the notebook, and physically secure the docking station to a stationary object using the security cable tab. Industry standard notebook locks are also supported.

### Key features:

#### HP DOCKING STATION (90W/230W)

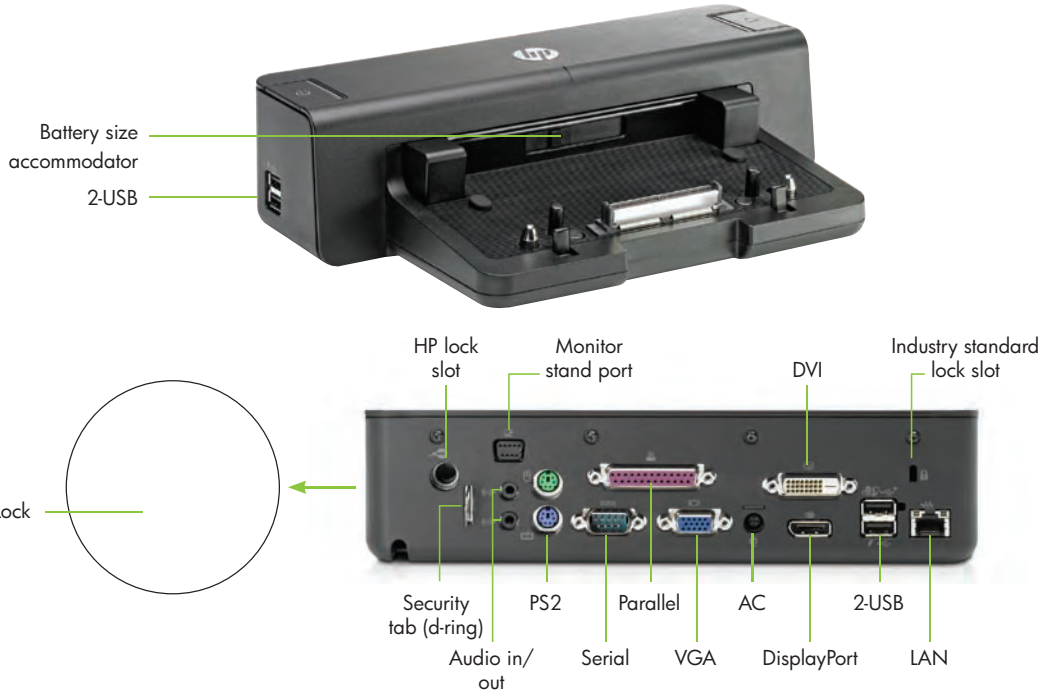

#### HP ADVANCED DOCKING STATION (120W/230W)

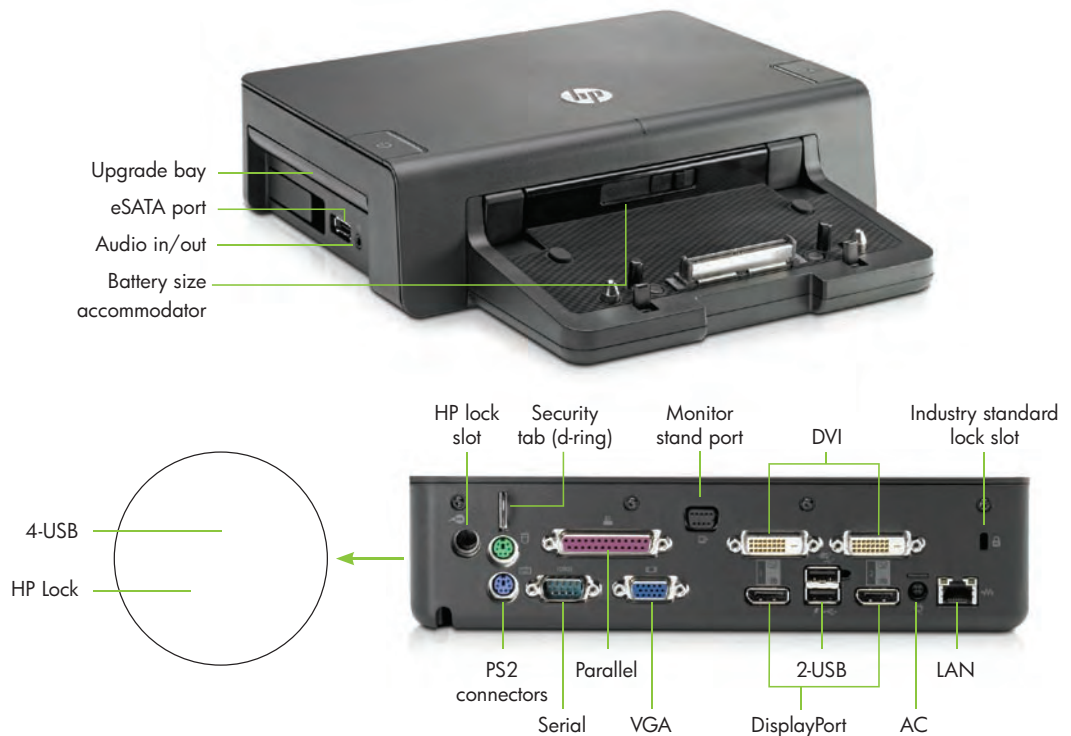

## Mobility, comfort and performance—perfectly matched

Now there's no need to compromise—HP Docking Stations let you create a desktop computing environment that strikes a perfect balance between mobility, comfort and performance. And with convenient, professional-grade accessories for HP business notebooks and docking stations, you can enjoy a workspace that helps optimize productivity while delivering a comfortable, stress-reducing computing experience.

### HP DOCKING STATION (90W/230W)



Spend more time focused on work and less time shuffling around cords with the HP Docking Station. This time-saving solution provides convenient port replication and cord management, plus room to grow as new technologies reach the market.

#### Key features and benefits:

- Four USB ports (three Always-On, one Powered) let you connect to the USB peripherals you use most for greater productivity.
- One DisplayPort connector, one Single-Link DVI port and one VGA port provide you with multiple choices for outputting digital video, as well as help facilitate compatibility with earlier technologies.
- The proprietary new HP Docking Station Cable Lock provides a simplified and enhanced security solution for protecting your data and hardware. In just a few easy steps, you can lock the docking station only, or lock both the docking station and your notebook.
- The Monitor Stand Port lets you add a monitor stand and external monitor for better, more comfortable viewing of information on-screen.

### HP ADVANCED DOCKING STATION (120W/230W)



Achieve new levels of productivity and enjoy greater convenience with the HP Advanced Docking Station. This easy-to-use docking system provides port replication and cable management in a single solution, and is proactively designed to accommodate future technologies as they become available.

#### Key features and benefits:

- Six USB ports (five Always-On, one Powered) let you easily connect to more peripherals, so you can stay productive.
- Two DisplayPort connectors, two Single-Link DVI ports and one VGA port provide you with multiple choices for outputting digital video, as well as help offer compatibility with earlier technologies.
- The proprietary new HP Docking Station Cable Lock provides a simplified and enhanced security solution for protecting your data and hardware. In just a few easy steps, you can lock the docking station only (which prevents access to the advanced dock's drive bay), or lock both the docking station and your notebook.
- The eSATA port offers faster data transfer rates for users who regularly work with large files. Ideal for graphics-intensive applications, this feature enables users, such as graphic designers, to store and manipulate data directly on their eSATA external hard drives.
- The Upgrade bay allows you to integrate a hard drive or optical drive in the dock so you can configure a solution to meet your needs. You can substitute the optical drive in the notebook for dual onboard drives, use the Upgrade bay to house the optical drive, or use a second hard drive to back up critical data when docking.
- The Monitor Stand Port lets you add a monitor stand and external monitor for better, more comfortable viewing of information on-screen.

### ADDITIONAL ACCESSORIES

Add these convenient accessories to your workspace for even greater comfort and productivity.



HP USB Keyboard/Mouse Bundle	RC465AA <sup>3</sup>
HP Adjustable Notebook Stand	PA508A
HP Monitor Stand	PA507A
HP Dual-Monitor Stand	AK084AA
HP Extended Life Battery	AJ359AA



## Leverage the power of HP Professional Innovations.

HP Docking Stations are just one of the many innovations that allow HP Business Notebook PCs to deliver an enhanced mobile computing experience. Together, these innovative hardware features and software solutions enhance security, improve ease of use and help provide reliability, all while keeping the environment in mind.

To learn more, visit  
[www.hp.com/go/professionalinnovations](http://www.hp.com/go/professionalinnovations).

### SPECIFICATIONS

	HP 90W Docking Station (VB041AA#XXX)	HP 230W Docking Station (VB043AA#XXX)	HP 120W Advanced Docking Station (NZ222AA#XXX)	HP 230W Advanced Docking Station (NZ223AA#XXX)
Total USB ports	4 (3 Always-On, 1 Powered)	4 (3 Always-On, 1 Powered)	6 (5 Always-On, 1 Powered)	6 (5 Always-On, 1 Powered)
DisplayPort connectors	1	1	2	2
DVI ports	1	1	2	2
VGA ports	1	1	1	1
Audio ports	2	2	2	2
Parallel ports	1	1	1	1
Serial ports	1	1	1	1
PS2 ports	1	1	1	1
Monitor stand port	1	1	1	1
LAN	Yes	Yes	Yes	Yes
Upgrade bay	No	No	Yes	Yes
eSATA port	No	No	Yes	Yes
HP Lock slot	Yes	Yes	Yes	Yes
Security tab (d-ring)	Yes	Yes	Yes	Yes

To learn more, visit [www.hp.com/accessories/notebook](http://www.hp.com/accessories/notebook)

2. Lock sold separately.
3. Availability may vary by region.

© Copyright 2009 Hewlett Packard Development Company, L.P. The information contained herein is subject to change without notice. The only warranties for HP products and services are set forth in the express warranty statements accompanying such products and services. Nothing herein should be construed as constituting an additional warranty. HP shall not be liable for technical or editorial errors or omissions contained herein.

