



Dell UltraSharp 25 Monitor U2515H 25"



Dell UltraSharp 25 Monitor | U2515H
63.44 cm (25 inches)

Experience multi-monitor viewing and Dell UltraSharp performance at its best

Enjoy brilliant QHD resolution and a virtually borderless viewing experience that's perfect for multi-monitor use with the uniquely sized 25" Dell UltraSharp 25 Monitor – U2515H.

For More Information visit
www.dell.com/monitors



Dell UltraSharp 25 Monitor | U2515H
63.44 cm (25 inches)



Dell UltraSharp 25 Monitor | U2515H
63.44 cm (25 inches)

The Dell UltraSharp 25 Monitor offers you:

World class screen performance

View images and documents easily with superb Dell UltraSharp screen clarity and precise colour performance on this unique 25" viewing area with brilliantly sharp QHD resolution.

- Enjoy consistent, accurate colours right out of the box — each Dell UltraSharp 25 Monitor is factory tuned at 99% sRGB with a $\Delta E < 3$.
- To enhance collaboration with co-workers, colours on the screen remain consistent from virtually any angle with this monitor's ultra-wide viewing angle.
- Experience great colour depth and detail with 16.78 million colours and exceptional screen clarity on a 25", 16:9 screen with QHD resolution of 2560 x 1440.
- Help boost productivity with easy multi-monitor setup thanks to daisy chain capabilities via DisplayPort out connectivity.
 - The ultra-thin bezel allows virtually borderless viewing between monitors.

Outstanding usability

Enjoy excellent connectivity and flexible viewing options that make the U2515H easy to use.

- Easily pivot 90° clockwise or counter-clockwise placing the thinnest edges side by side for an enhanced screen experience with a multi-monitor set up.

Perfect for dual/multi-monitor set up to promote increased productivity.

Recommended for:

- Traffic control monitoring
- Programming and software development
- Office applications

- Work the way you like with the fully adjustable U2515H including tilt, pivot, swivel and height adjustable stand features.
- Connect seamlessly to your PC and other peripherals simultaneously without compromising on picture quality via digital connectivity.
- Display content from your smartphone or tablet directly on the large monitor screen and charge it at the same time when you connect either device via MHL to your U2515H monitor.
- A high current USB 3.0¹ charging port supplies twice the power for charging and powering BC1.2 compatible devices.
- Gain enhanced productivity with Dell Display Manager which houses applications that can be customised easily like Auto Mode, Easy Arrange and Power Nap.

Reliability and eco-efficiency

- Minimise downtime and gain peace of mind with:
 - Premium Panel Guarantee² which offers a free panel exchange in the event that you discover even one bright pixel during the Limited Hardware Warranty³ period.
 - Dell's 3-year Limited Hardware Warranty and Advanced Exchange Service⁴, providing you with quality you can count on.
- Made of environmentally preferable materials, the U2515H is designed with more than 25% post consumer recycled materials in its chassis, is BFR/PVC-free (excluding external cables), arsenic-free glass and a mercury-free LED panel.
- Rest assured that the U2515H meets the latest environmental standards such as ENERGY STAR®, EPEAT® Gold⁵ and TCO Certified Displays.

Thank you
for making
Dell monitors

#1
Worldwide*

Easily adjust the panel to your preferred viewing position to work the way you like.

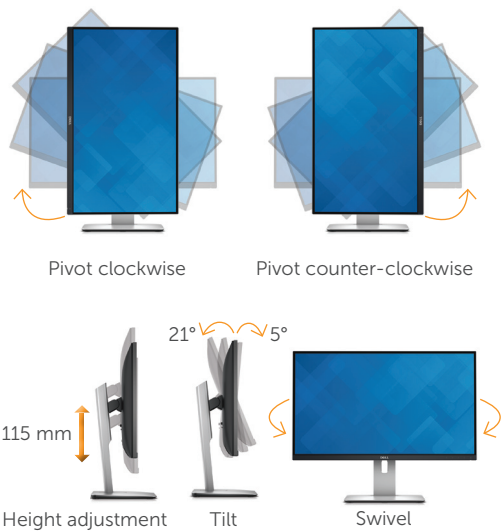

Connectivity

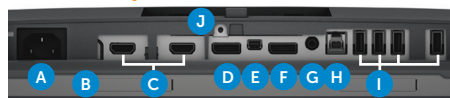

- A** AC power
- B** Dell soundbar mounting slots
- C** HDMI (MHL)
- D** DisplayPort in
- E** Mini DisplayPort in
- F** DisplayPort out (MST)
- G** Audio-Line out
- H** USB upstream
- I** USB downstream
- J** Stand lock



What's in the box?
 Monitor, stand, cable cover, power cable (varies by country), DisplayPort cable (mini-DP to DP), USB 3.0 upstream cable (enables the USB ports on the monitor), drivers and documentation media, quick set up guide, product and safety information guide, Factory Calibration Report.

Dell recommends that customers dispose used computer hardware, including monitors, in an environmentally sound manner. Potential methods include reuse of parts or whole products and recycling of product, components and/or materials. For more information, please visit http://dell.com/recycling_programs and www.dell.com/environment

Dell UltraSharp 25 Monitor | U2515H

Display	
Model number	U2515H
Viewable image size (diagonal)	63.44 cm (25 inches)
Active display area	
Horizontal	552.96 mm (21.77 inches)
Vertical	311.04 mm (12.25 inches)
Maximum resolution	QHD 2560 x 1440 at 60 Hz
Aspect ratio	16:9
Pixel pitch	0.216 mm
Brightness (typical)	50 to 350 cd/m ²
Colour gamut (typical)	99% sRGB (delta E < 3), 91% ⁶ (CIE1976)
Colour depth	16.78 million colours
Contrast ratio (typical)	1000:1
Dynamic contrast ratio (max)	2 million:1
Viewing angle (typical) (vertical/horizontal)	178° / 178°
Response time (typical)	Fast mode: 6 ms gray-to-gray (typical) Normal mode: 8 ms gray-to-gray (typical)
Panel technology	In-plane switching, anti-glare with hard coat 3H
Backlight	LED
Speakers (optional)	Dell Speaker Bar AC511
Connectivity	
Connectors	2 x HDMI(MHL), 1 x Mini DisplayPort/ DisplayPort 1.2 ⁷ , 1 x DisplayPort out (MST), 1 x Audio Line out, 5 x USB 3.0 ports
Design features	
Stand	Height-adjustable stand, tilt (typical: 5° forward or 21° backward), pivot (clockwise and counter-clockwise), swivel and built in cable-management
VESA mounting support (wall mount kit sold separately)	Dell Quick Release feature (100 mm x 100 mm)
Security	Security lock slot (security lock not included)
Power	
AC input voltage/frequency/current	100 to 240 VAC/50 or 60 Hz ± 3 Hz/1.5 A (typical)
Power consumption (typical)	35W
Power consumption standby/sleep mode	<0.5 W
Dimensions (with stand)	
Height (compressed ~ extended)	398.0 mm (15.67 inches) ~ 512.5 mm (20.18 inches)
Width	569.0 mm (22.40 inches)
Depth	205.0 mm (8.07 inches)
Weight	
Weight (panel only – no stand)	4.4 kg (9.64 lb)
Weight (with stand)	6.8 kg (14.96 lb)
Shipping weight	9.8 kg (21.56 lb)
Standard service plan	
<ul style="list-style-type: none"> • 3 Years Advanced Exchange Service⁴ & 3 Years Limited Hardware Warranty³ • Premium Panel Guarantee² 	
Environmental compliance	
ENERGY STAR ⁵ , EPEAT ⁶ Gold ⁵ , TCO Certified Displays, China Energy Label, RoHS, WEEE, ErP (EuP) Standards, Korea E-Standby	

*Dell monitors are #1 Worldwide in 2013. Dell monitors are #1 in North America for the last 14 years (2000 to 2013). Source: NP DisplaySearch Quarterly Desktop Monitor Shipment and Forecast Report. (Ad#G14000221)

** Registered in US and Canada only.

¹ For charging BC1.2 devices and also supports up to 2A when powering standard USB devices.

² In the event you discover even one bright pixel during the Limited Hardware Warranty period, a free panel exchange is guaranteed. (see pixel panel info located on Dell.com web page for complete details): <http://support.dell.com/support/topics/global.aspx/support/kcs/document?docid=414288>

³ For a copy of the Limited Hardware Warranty, write Dell Products, Dell House, The Boulevard, Cain Road, Bracknell, Berkshire, RG12 1LF, UK or see dell.com/warranty.

⁴ Advanced Exchange Service: Replacement part/unit dispatched, if needed, following completion of phone/online diagnosis. Fee charged for failure to return defective unit. Availability varies. Other conditions apply.

⁵ EPEAT Gold registered in the U.S. EPEAT registration varies by country. See www.epeat.net for registration status by country.

⁶ Colour gamut (typical) is based on CIE1976 (91%) and CIE1931 (76%) test standards.

⁷ DisplayPort 1.2 - Supports High Bit Rate 2 (HBR2) and Multi-stream transport (MST). U2515H does not support fast AUX transaction, 3D stereo transport and HBR (High bit rate) audio.

Based on Ad# A14000519 dell.co.uk/monitors

Product availability varies by country. Please contact your Dell representative for more information.

